

**RON1006-50-12.5K**  
8.5mm Hole 12.5mm Recess  
304/316

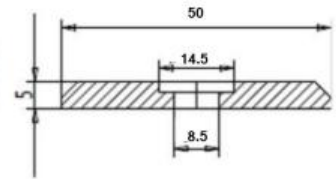

**RON1006-50-14.5K**  
8.5mm Hole 14.5mm Recess  
304/316

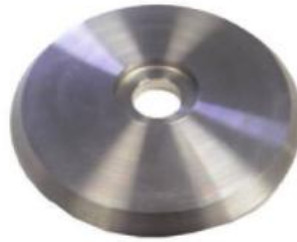
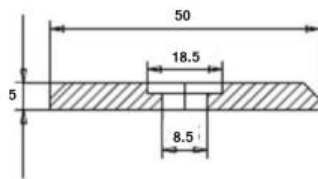

**RON1006-50-18.5K**  
8.5mm Hole and 18.5mm Recess  
304/316

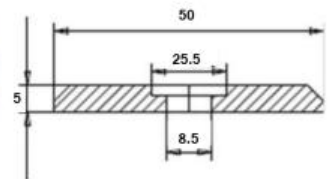

**RON1006-50-25.5K**  
8.5mm Hole and 25.5mm Recess  
304/316

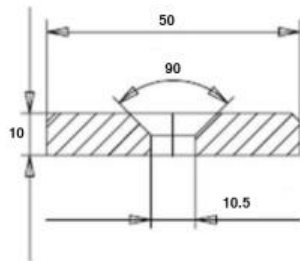

**RON1008-50K**  
50mm Plate 10.5mm CSK  
304/316

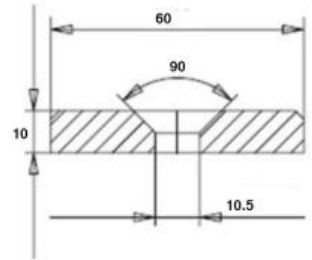

**RON1008-60K**  
60mm Plate 10.5mm CSK  
304/316

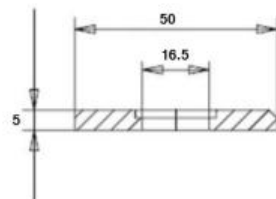

**RON1005-50-K**  
50mm Plate 16.5mm Recess  
304

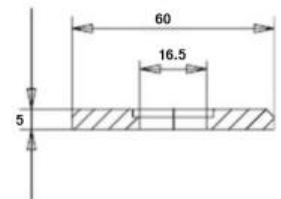

**RON1005-60K**  
60mm Plate 16.5mm Recess  
304/316

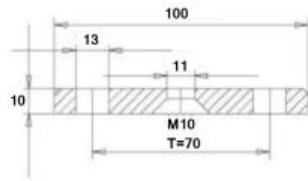

**RON1001K-100-M10**  
M10 x 100 x 2 Holes  
304/316

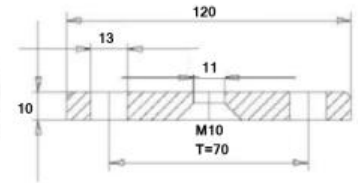

**RON1001K-120-M10**  
M10 x 120 x 2 Holes  
304/316

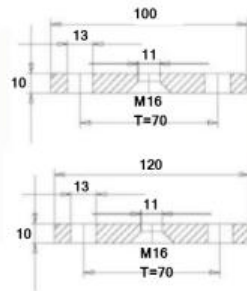

**RON1001K-100-M16** - M16 x 100 x 2 Holes  
**RON1001K-120-M16** - M16 x 120 x 2 Holes  
304/316

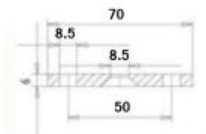

Plain Holes

**RON1004K**  
70 x 6mm Plate  
2 x 8.5mm Holes  
304/316

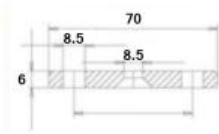

Countersunk Holes

**RON1004-3HOLE**  
70 x 6mm Plate  
2 x 8.5mm Holes  
304/316

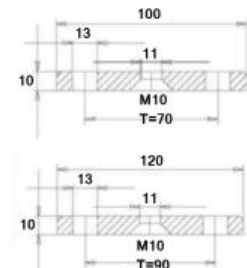

**RON1002K-100-M10** - M10 x 100 x 3 Holes  
**RON1002K-120-M10** - M10 x 120 x 3 Holes  
304/316

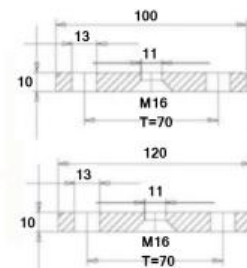

**RON1002K-100-M16** - M16 x 100 x 3 Holes  
**RON1002K-120-M16** - M16 x 120 x 3 Holes  
304/316

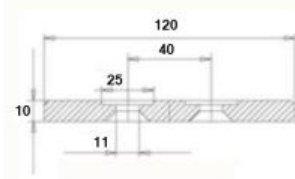

**RON1003-120-M16**  
12 22 02 - 120mm Wall Plate  
304/316

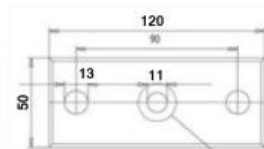

**RON1007K**  
M10 - 120 x 50mm / M16 - 140 x 60mm  
304/316