

*Test reports are available upon request

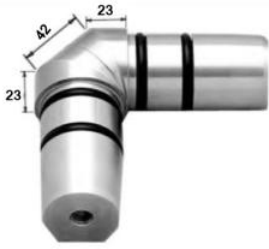

RV1006/50.8
Adjustable Angle Bend
316



RV1008-50.8
90 Degree Radius Bend
304/316

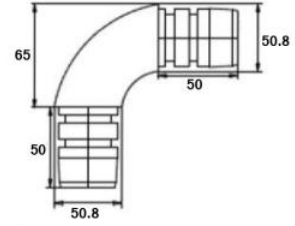

RV1005-50.8-Special
Pre-Drilled 90 Degree Sharp Bend for Saddle
316

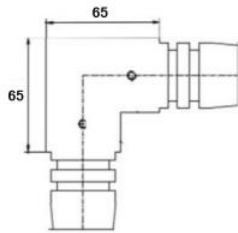

RV1005-50.8
90 Degree Sharp Bend
304/316

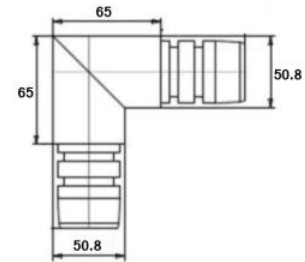

RV1007/50.8
45/135 Degree Set Angle Connector
316

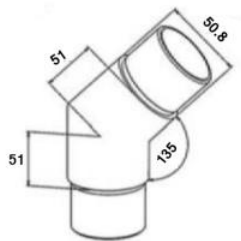

RV1001/50.8
Straight Connector
304/316

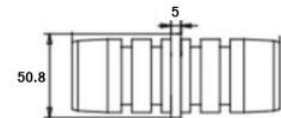

RV1009-50.8
Rotatable Elbow
316

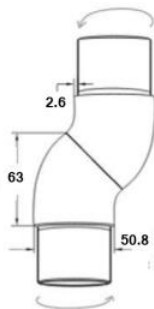

RV1004K-Adjust-50.8
Adjustable Angle Changer
316

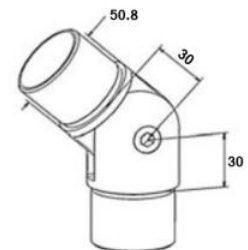

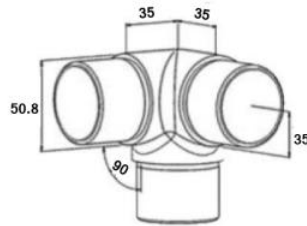

EVB1009K-50.8
3 Way Hollow Corner
316

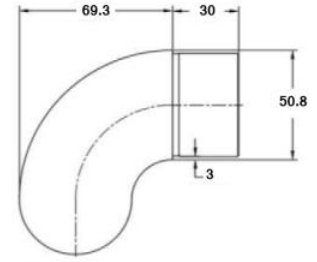

RV1018-50.8K-Rounded
Rounded End Scroll
304/316

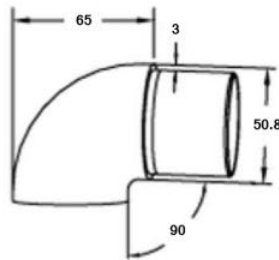

RV1018
Blank End Scroll
316

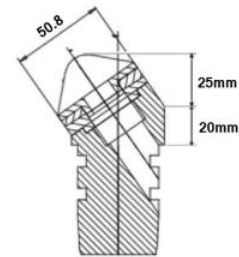

RA1004-35-316-50.8
30-40 Degree (+/-5) Insert
304/316



RA1011-50.8
0-40Degree Adjustable Angle
304



GLS1001K-316-50.8
Adjustable Angle Insert

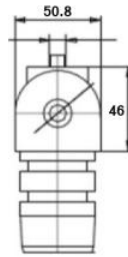

RA1006/50.8
Adaptor 50.8 Ali Insert
304/316

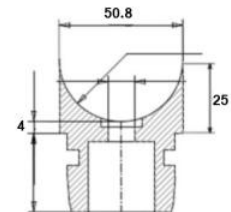

RA1005/50.8
90 Degree Corner Insert
Outlet Adaptor
304

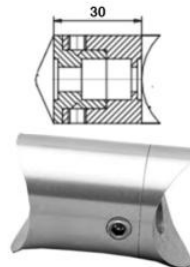
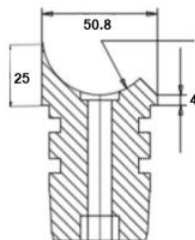

RA1010
50/50mm Connector
304

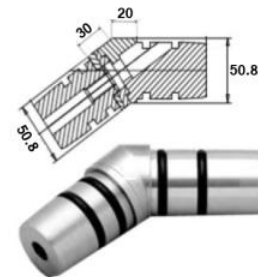
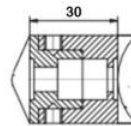

RV1004-25-316-50.8
20-30 Degree Angle Changer

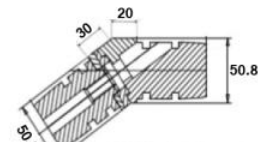

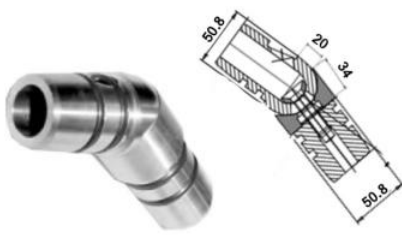

RV1011-50.8
0-40 Degree Angle Changer

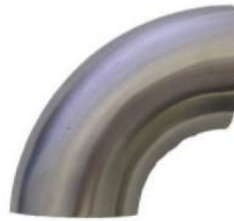

ROB-50.8K
Weldable Elbow x 2mm
304/316

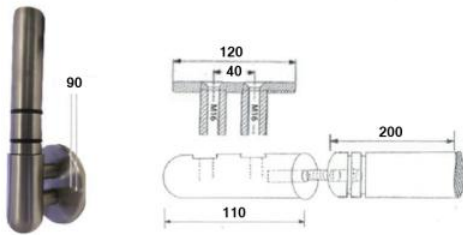
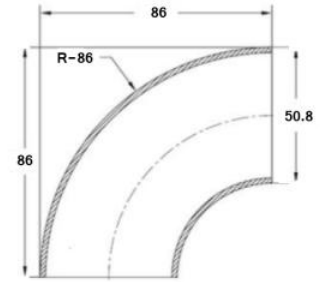

WND1005-30/50/80
30/50/80mm Offset
304/316



WND1001-CLIP
Offset different to complete unit
304/316

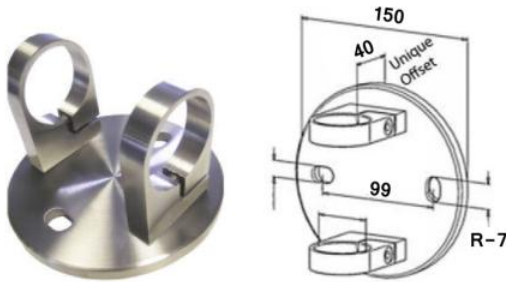

WND1001-50.8
40mm Offset Side Fix Bracket
304/316



WND1008-50.8
40mm Offset Internal/External Corner
304/316

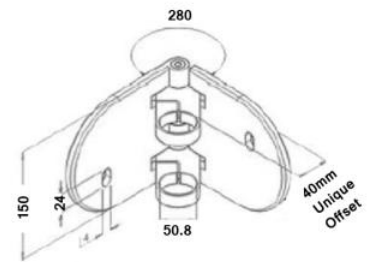

BDH1005/100/50.8
200mm Spigot and
100mm Plate - 3 x
M13 Fixing Holes
304/316



BDH1005/120/50.8
200mm Spigot and
120mm Plate - 3 x
M13 Fixing Holes
304/316



BDH1005x100mm
Smaller 68mm
Spigot x 100mm
Plate - 3 x M13
Fixing Holes
304/316



BDH1005x120mm
Smaller 68mm
Spigot x 120mm
Plate - 3 x M13
Fixing Holes
304/316



RHT1005-316x68mm
68mm High Spigot x M16

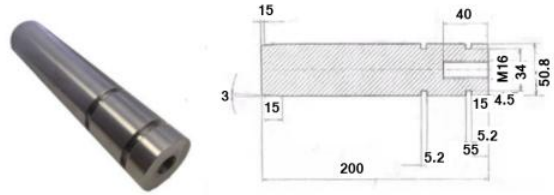

RHT1005K-200-50.8
200mm Solid Spigot
x M16
304/316

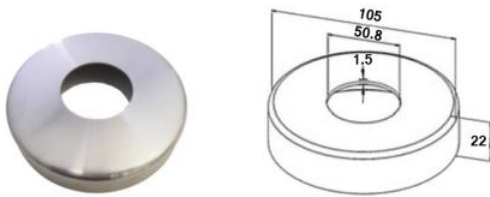

ROS1001-50.8
Cover Plate
304/316

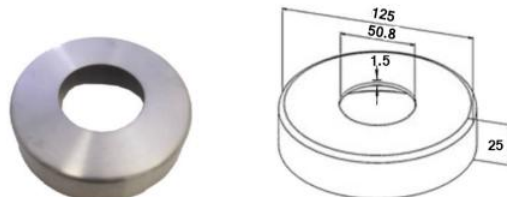

ROS1002-50.8
Cover Plate
304/316



ROS1004-50.8-316
Diamond Hole Cover Plate
316

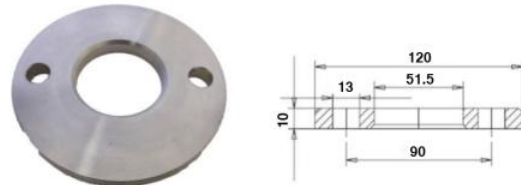

RON1010/50.8
Weldable Plate
304/316

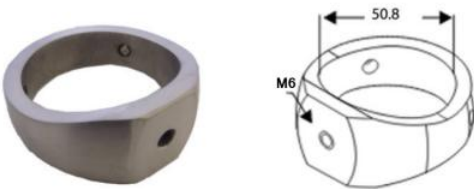

M6-CLIP
Clip with 2 x M6 Tapped Holes
304/316



BDH1010-60-316
60mm Plate x 50.8mm
Ali Insert
304/316



BDH1011-50.8mm
50.8 x 60mm Through
Fix - Ali
304



HH1011-304-50.8
Handrail Insert - 50 Degrees
Offset with M8
304



HH1061-50.8
Convex Top Handrail
Insert with M8
304/316



HH1060K-50.8
Flat Top Handrail
Insert With M8
304/316



HH1040-304-50.8
Handrail Support
Drilled to Take 15mm
Rod and M8
304



HH1050-50.8mm
Ball with 50mm
Hole
304



**Sample Assembly for
Open Treads**
304/316



RO1001-50.8
x 3mm Wall Tube
304/316
Satin/Mirror

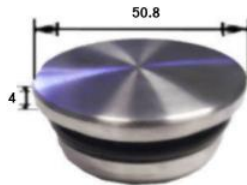

EK1002-50.8
Flat End Cap (Solid)
304/316



EK1010K-50.8
Convex End Cap (Solid)
304/316



EK1018-50.8
Dome End Cap (Solid)
304/316

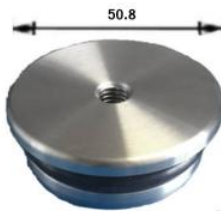

EK1006/50.8
Flat End Cap (Solid)
304/316
Drilled M8

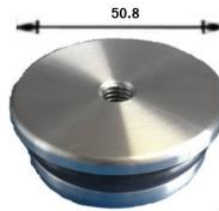

EK1014-50.8
Convex Drilled M8 End Cap
304/316

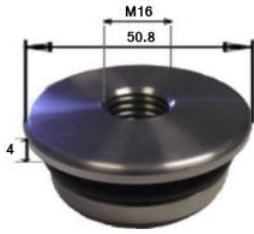

EK1006-304-50.8
Flat Drilled M16 End Cap
304/316



HH1005-50.8mm
Straight Complete
Bung/Stem/Saddle
304/316



HH1008-50.8mm
Adjustable Complete
Bung/Stem/Saddle
304/316



HH1003Y - 75mm Offset - 304/316
HH1003K - 90mm Offset - 304/316

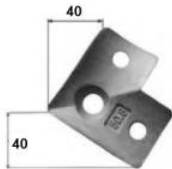

HH1001K-Z-50.8
90 Deg Angle Saddle
316

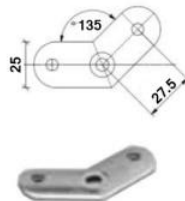

HH1001K-45-50.8
45 Deg Angle Saddle
316

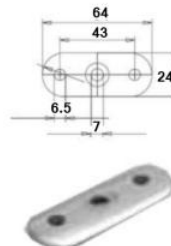

HH1001K-H-50.8
Straight Saddle
304/316



RON1014-140
Weldable Plate
304/316

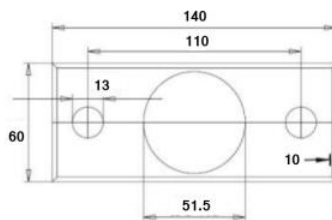

WALLPLATE-50.8
Wall Plate with 3 x M6 Fixing Holes
316

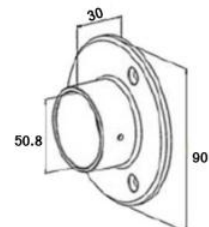

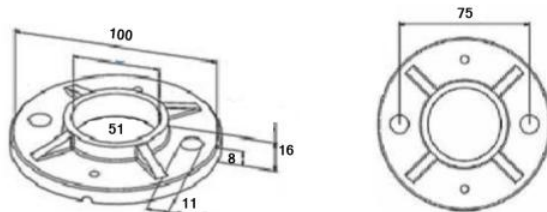

RON1012-50.8
Raw Weldable Plate
304/316

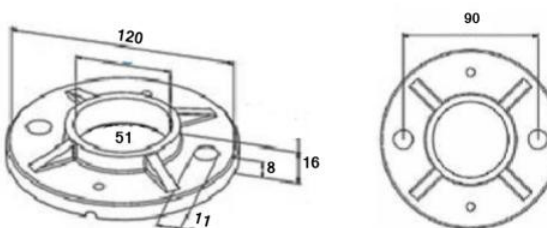

RON1011-50.8
Raw Weldable Plate
304/316

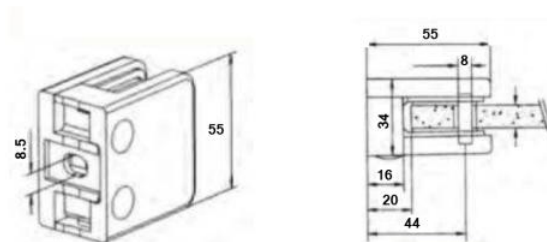

KLH12R-50.8
Square Glass Clamp 55 x 55mm
304/316



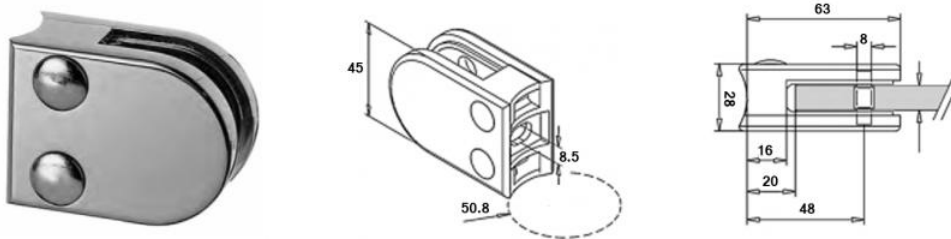

- KLH10R-K-304 (304G Satin, 50.8mm 6-12mm Glass)
- KLH10R-50.8K (316G Satin, 50.8mm 6-12mm Glass)
- KLH10R/M-50.8 (304G Mirror, 50.8mm 6-12mm Glass)
- KLH10R-K-316M (316G Mirror, 50.8mm 6-12mm Glass)
- KLH10U-50.8K (Untreated, 50.8mm 6-12mm Glass)
- KLH10Z-50.8(K) (Zintec, 50.8mm 6-12mm Glass)

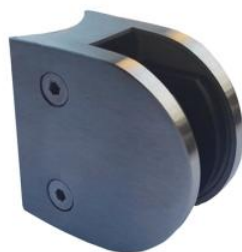

- KLH21.5MM-R-316
- Suitable for 15, 17.52, 19 and 21.52mm Glass
- 316 Grade - Satin / Mirror - 48.3 / 50.8mm Tube
- (Also available with a 'Flat Back')

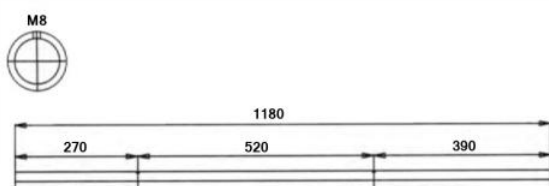
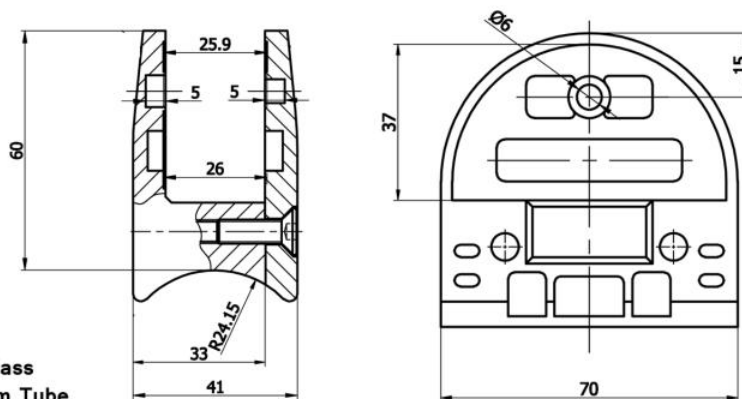

SP1001 - 1180mm High
End Post 2 x M8 pre-drilled holes at 520mm c/c

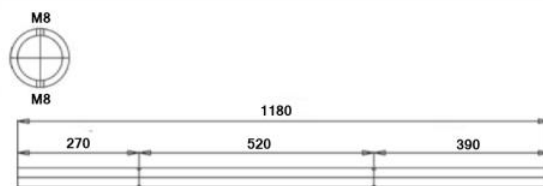

SP1002 - 1180mm High
Mid Post 4 x M8 pre-drilled holes by 180 degrees. Holes at 520mm c/c

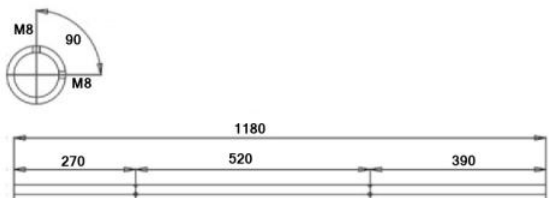

SP1003 - 1180mm High
90 Degree Corner Post 4 x M8 pre-drilled holes at 520mm c/c

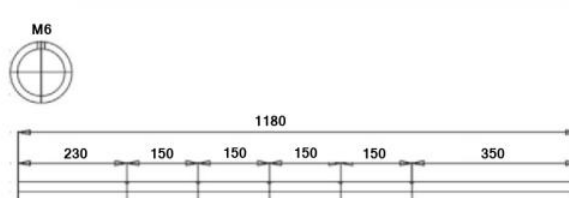

SP1004 - 1180mm High
5 x M6 pre-drilled set at 150mm c/c
Ideal for rod and wire fittings

System Posts are also Available in 304 & 316 Grades and Satin & Mirror Finishes