

*Test Reports Available Upon Request

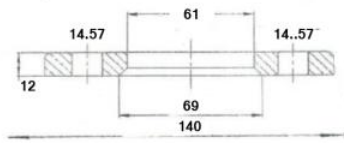

RON140-12
Weldable Base Plate
316

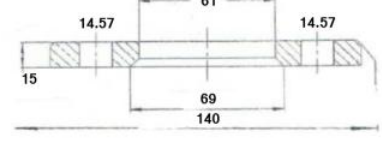

RON140-15
Weldable Base Plate
316

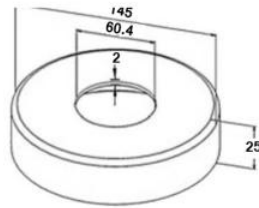

ROS140-61
Satin Cover Plate
316

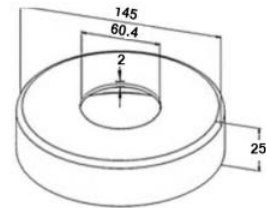

ROS140-61-MIRROR
Mirror Polished Cover Plate
316

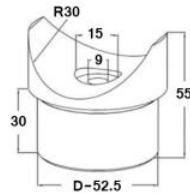

RA1006-60.3-316
Top Rail Insert
316 Satin

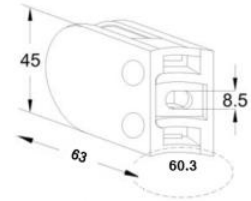

KLH10D-60.3
Glass Clamp + 10mm Rubber Inserts
(Rubbers Also Available for 6/8/12mm Glass)
316 Satin

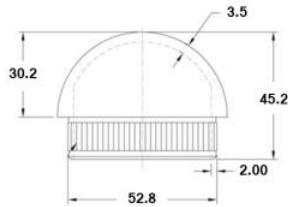

W270-4MM
Dome End Cap
316 Satin

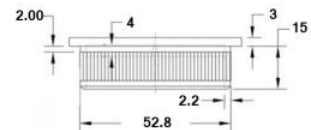

W268-4MM
Flat End Cap
316 Satin

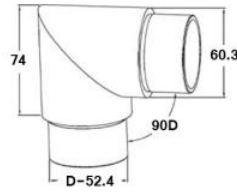

RV1005-60.3-316
90 Degree Sharp Bend
316 Satin



RV1001-60.3-316
Straight Tube Connector
316 Satin

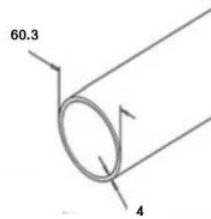

RO1001-60.3X4MM
316 Satin (320 Grit)

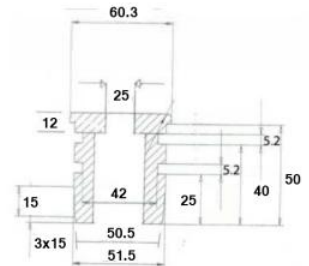

HH1060-60.3-316
Top Insert 25mm Threaded Hole
316 Satin

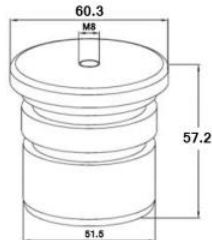

HH1060-60.3-M8
Top Insert M8 Threaded Hole
316 Satin

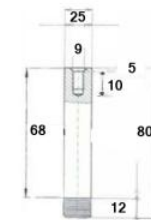

HH1002H-25-60.3
Fixed Stem
316 Satin

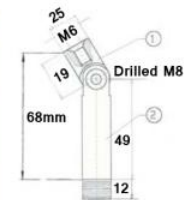

GLS1002K-60.3-316
Stem + Swivel Neck

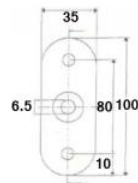

HH1001K-60.3-316
Straight Saddle
316 Satin

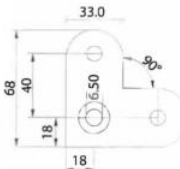

HH1001K-Z-60.3-316
90 Degree Corner Saddle
316 Satin

