

*Test reports are available upon request

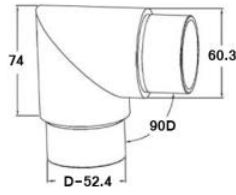

RV1005-60.3-316
90 Degree Sharp Ben

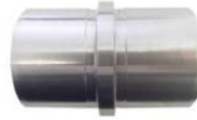

RV1001-60.3-316
Straight Tube Connector

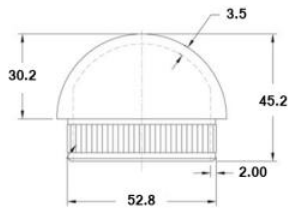

W270-4mm
Dome End Cap

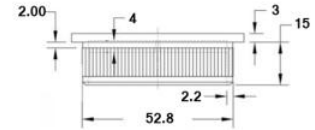

W268-4mm
Flat End Cap

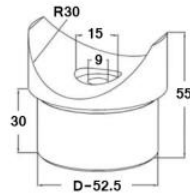

RA1006-60.3-316
Top Rail Insert

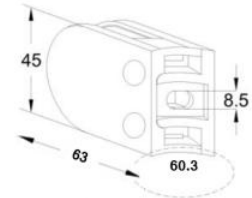

KLH10D-60.3
Glass Clamp 304/316G - Satin
Rubbers also available for 6/8/12mm Glass

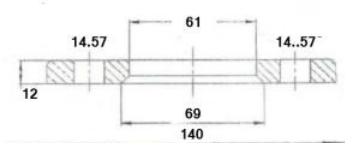

RON140-12
Weldable Base Plate
304/316

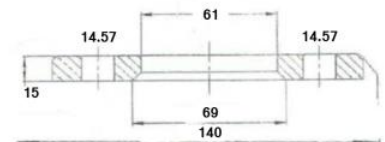

RON140-15
Weldable Base Plate
304/316

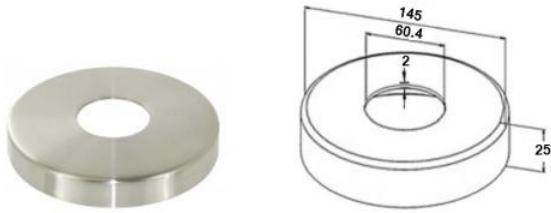

ROS140-61
Satin Cover Plate
304/316

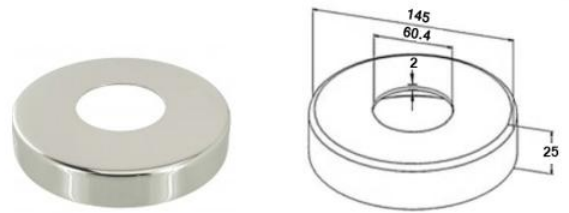

ROS140-61-Mirror
Mirrored Cover Plate (316)

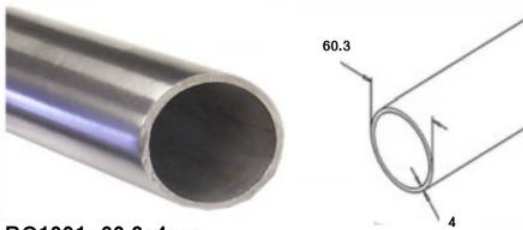

RO1001-60.3x4mm
(316G Satin 320Grit)

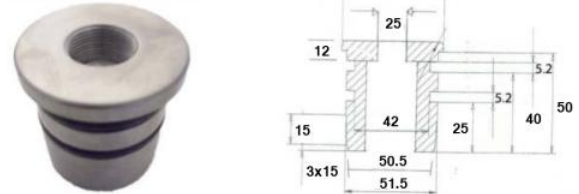

HH1060-60.3-316
Top Insert with 25mm threaded hole
316



HH1060-60.3-M8
Top Insert with M8 threaded hole
316

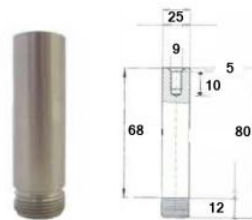

HH1002H-25-60.3
Fixed Stem - 316



GLS1002K-60.3-316
Stem with Swivel Neck

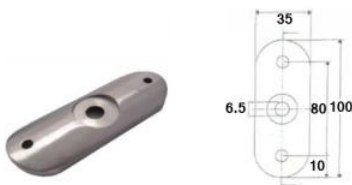

HH1001K-60.3-316
Straight Saddle



HH1001K-Z-60.3-316
90 Degree Corner Saddle

